

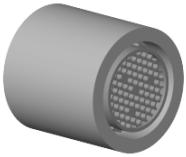











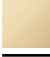



90 23 01 028 02

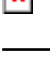

	Platin gebürstet	90 23 01 028 02-06
	Chrom	90 23 01 028 02-00
	Platin	90 23 01 028 02-08
	Messing (23kt Gold)	90 23 01 028 02-09
	Weiß matt	90 23 01 028 02-10
	Dark Brass matt	90 23 01 028 02-16
	Dark Bronze matt	90 23 01 028 02-17
	Dark Chrome	90 23 01 028 02-19
	Messing gebürstet (23kt Gold)	90 23 01 028 02-28
	Schwarz matt	90 23 01 028 02-33
	Bronze gebürstet	90 23 01 028 02-42
	Champagne gebürstet (22kt Gold)	90 23 01 028 02-46
	Champagne (22kt Gold)	90 23 01 028 02-47
	Cyprum	90 23 01 028 02-49
	Chrom gebürstet	90 23 01 028 02-93
	Dark Platin gebürstet	90 23 01 028 02-99



Luftsprudler Niederdruck M18x1G - Platin gebürstet

ERSATZTEILE

90 23 01 028 02



Luftsprudler Niederdruck M18x1G - Platin gebürstet

ERSATZTEILE

90 23 01 028 02

90 23 01 028 02

Ersatzteile für die
anderen
Oberflächenvarianten
finden Sie hier:
Chrom

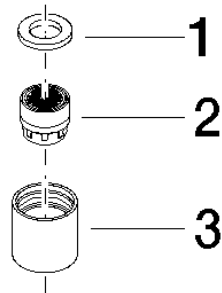

Ersatzteilstückliste

Nr.	Artikelnummer	Benennung	Verbaumenge	Lieferzeit
3	09 23 01 028-06	Luftsprudlerhülse Ø 20 x 20 mm - Platin gebürstet	1,00	10
1	90 14 05 020 00 90	Dichtung 16,7 x 10,0 x 2,0 mm -	1,00	2
2	09 29 03 010 90	Luftsprudlereinsatz M18 8,3 l/min. -	1,00	2