

**Vanity unit without / with cut out**

**40900.0**

**40900.3**



**TECHNICAL DATA**

Order no.	40900.0 / without cut out 40900.3 / 1 cut out	Accessories excl.	Power socket (EU), IP44, order no. 49298.4 Power socket (CH), IP44, order no. 49298.5 Drawer separations (not recommended with shelf) small, order no. 40920.0 Space saving siphon, order no. 89424.0
Dimensions (WxHxD)	900 x 360 x 380 mm	Mounting acc. incl.	Installation set for furniture, order no. 49120.6
Matching for washbasin	see table below	Mounting information	The walls installed on must meet the requirements of the furniture in terms of weight and the supplied fastening elements. If this cannot be guaranteed another method of installation needs to be chosen. For example with feet.
Specification	Body/Front – lacquered surface veneer with solid wood edges Slim front with a 4 mm rim 1 push and pull full extension drawer without or with cut out	Colours	250 – Light oak 251 – Dark oak
Weight	22,0 kg		
Accessories excl.	Shelf L shaped for drawer, with pre-drilled holes in the back (left and right) for optional power socket, depth 90 mm, order no. 40924.1 depth 150 mm, order no. 40924.2		

**TECHNICAL DRAWINGS / S 1 : 20**

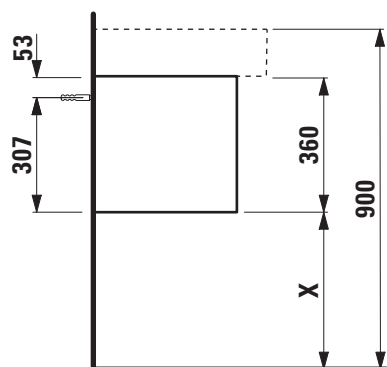
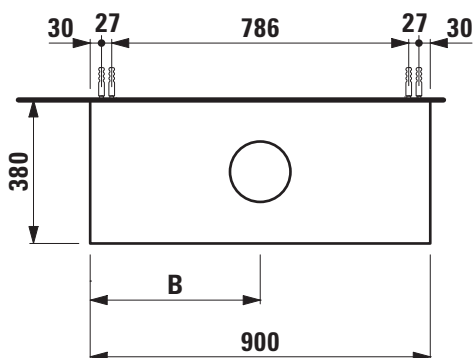

B / mm	Ceramic
300	Kartell by Laufen 81033.8 (possibility for asymmetric position on request)
376	Kartell by Laufen 81033.4
450	Kartell by Laufen 81533.1 Ino 81630.0, 81630.2 Val 81628.0, 81628.2, 81628.3, 81628.4, 81628.5

B / mm	Ceramic
525	Kartell by Laufen 81033.5
600	Kartell by Laufen 81033.9 (possibility for asymmetric position on request)

X = The exact height must be set during installation.