



HANSA

Installation and maintenance guide



4, 17-18



5-13



14

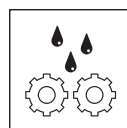

15-16



18

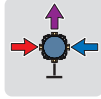

1019428V

EN 817
100 - 1000 kPa
max. +90°C

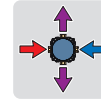
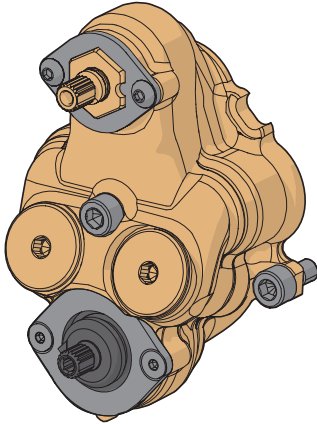

1018613V

EN 817
100 - 1000 kPa
max. +90°C

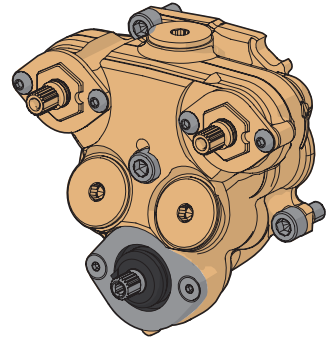

8810 9000

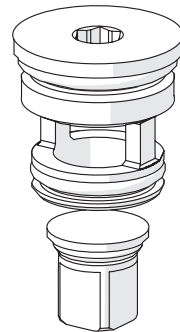

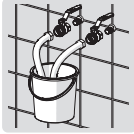
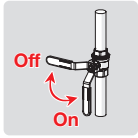

EN 1717
EN 806-5

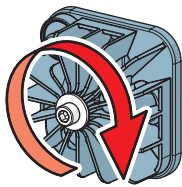

90°

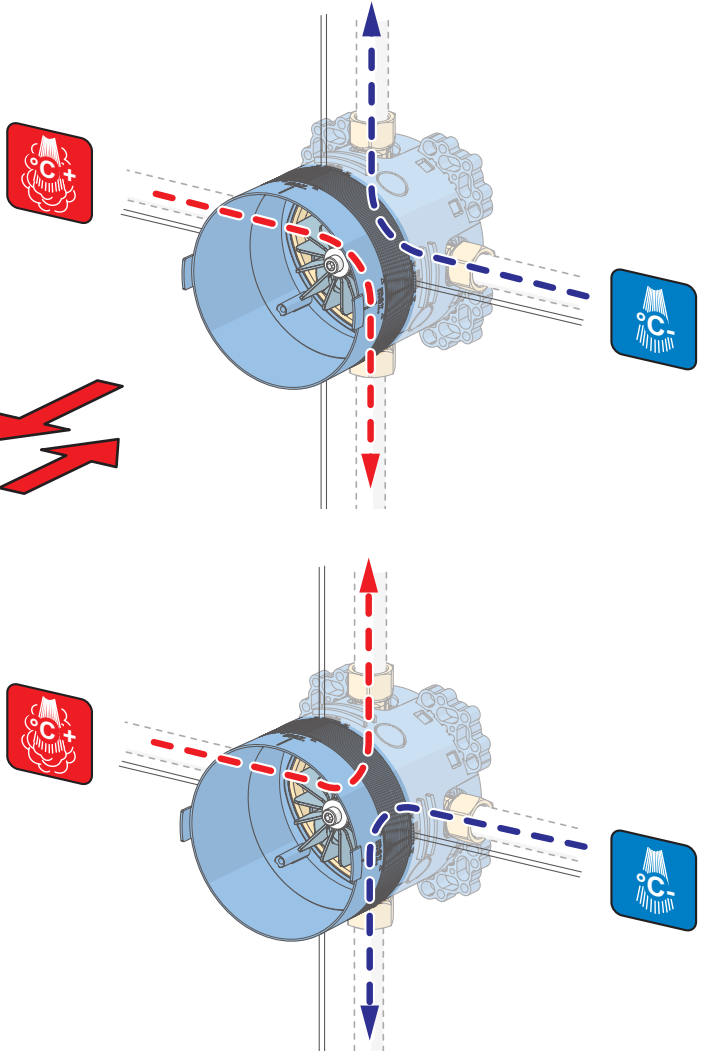

59 914 185

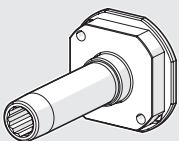

Rinsing tube

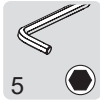

5

②

②

A

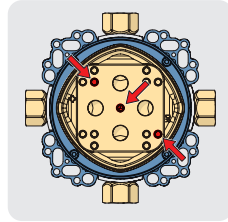
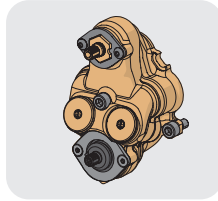

1x

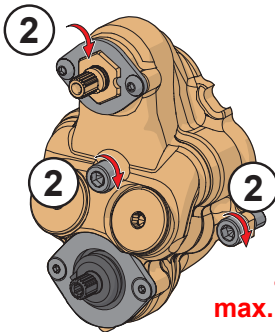

①

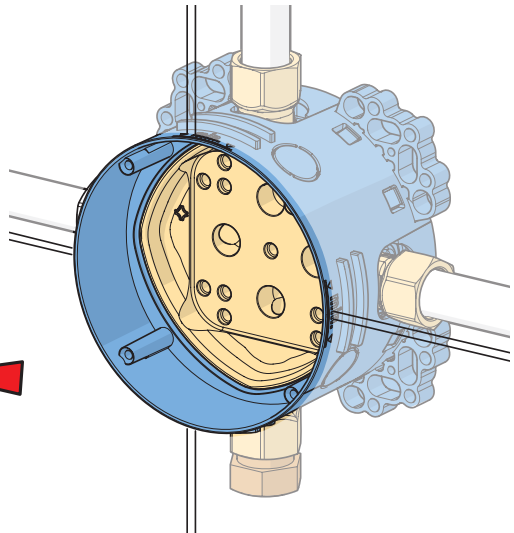

max. 12 Nm





5

②

②

B

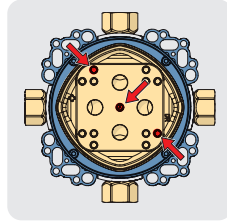
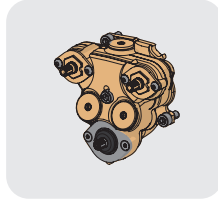

2x

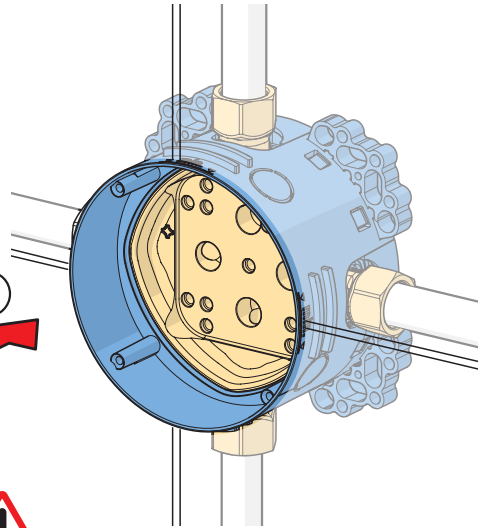
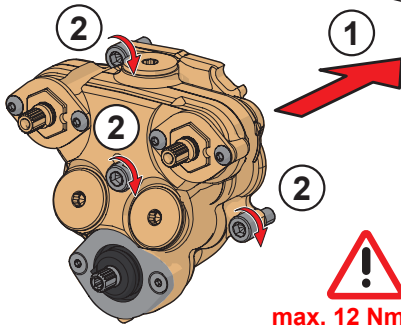



2

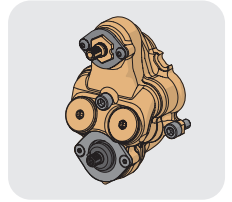
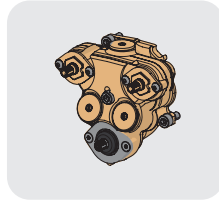

3

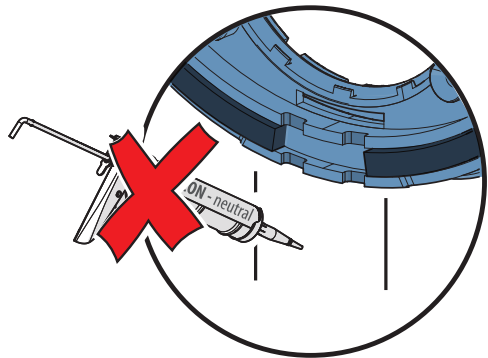
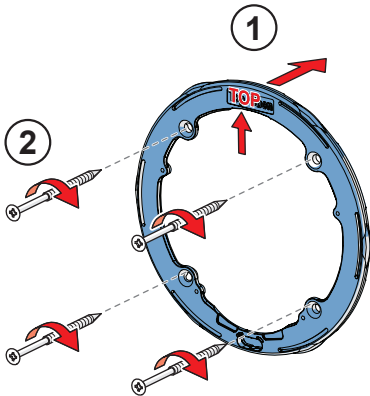
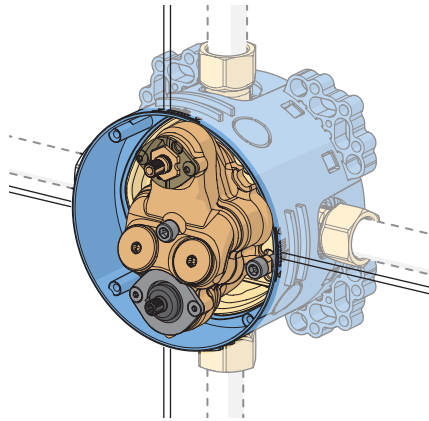

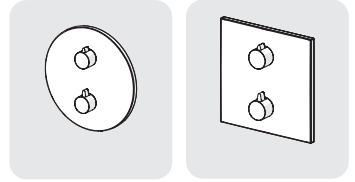
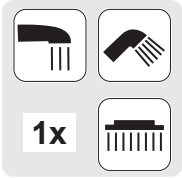

4 **A**

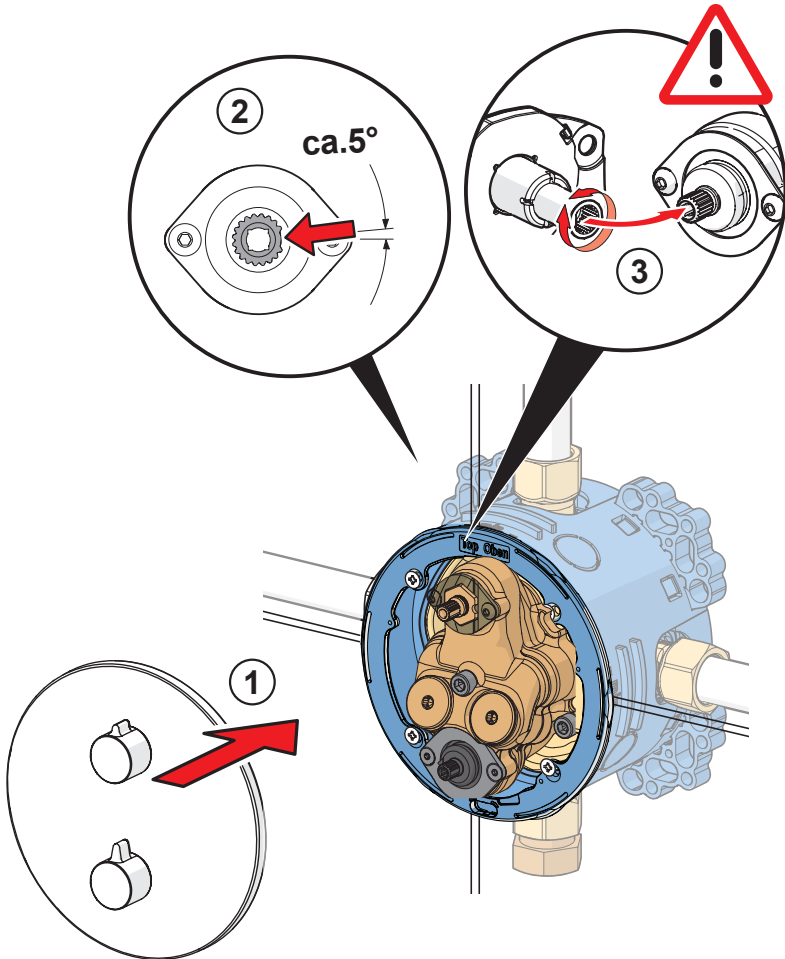

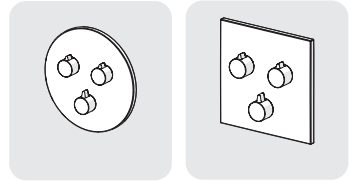
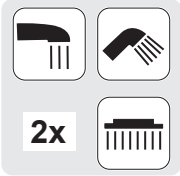

4 B

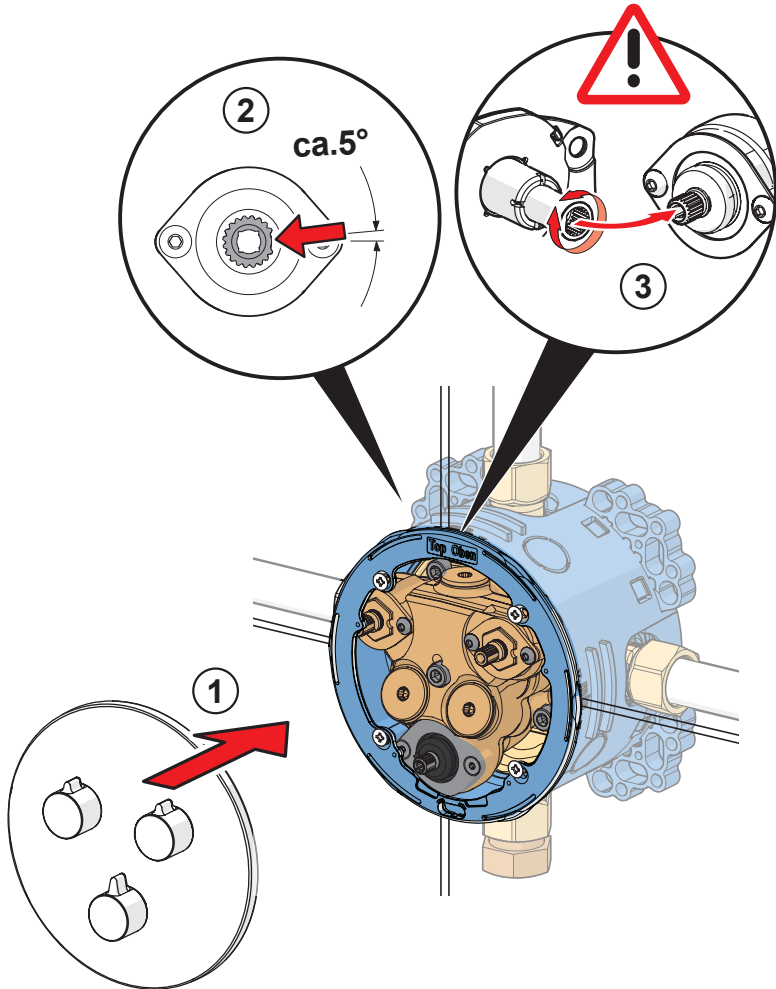

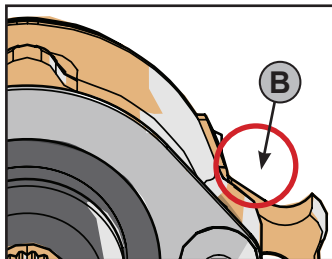
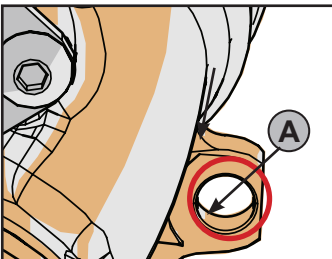
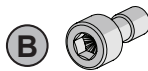
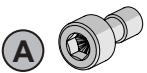
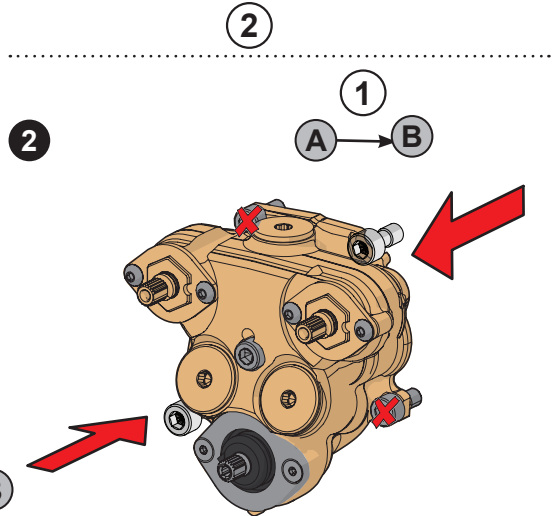
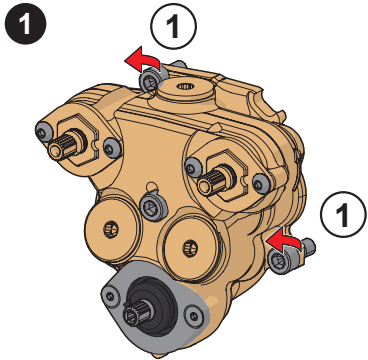
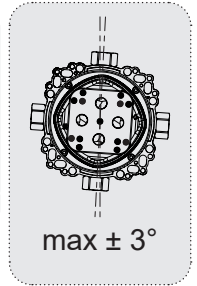
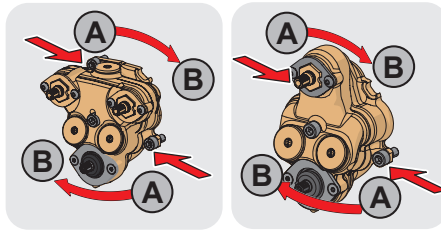
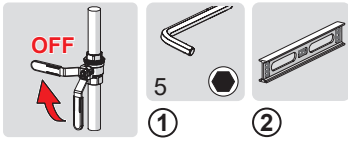



5

1

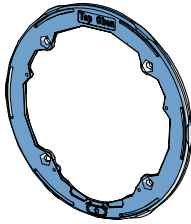

2

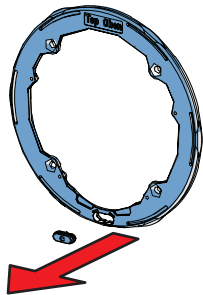

3

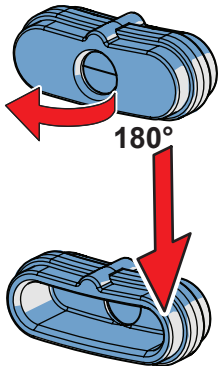

4

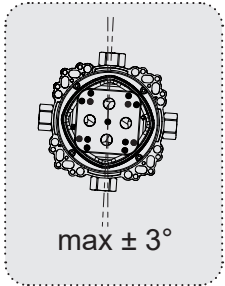
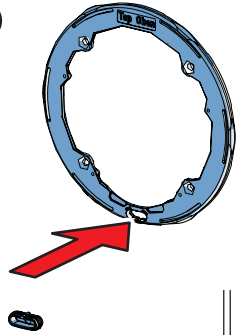

5

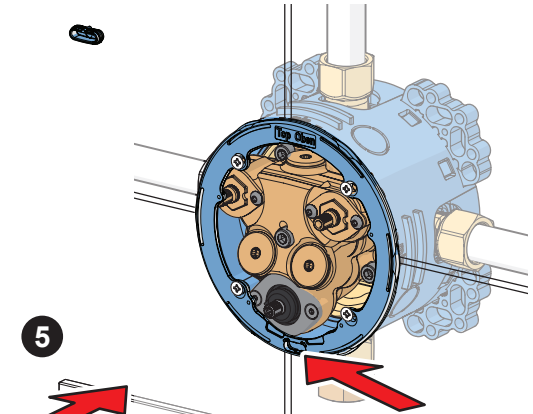

6

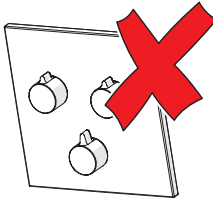
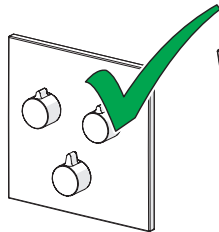
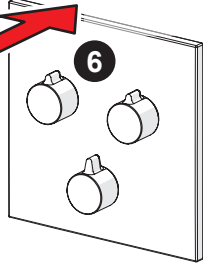

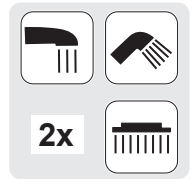
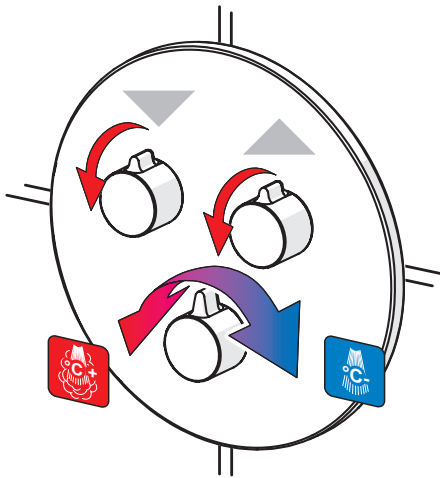
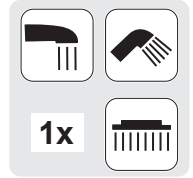
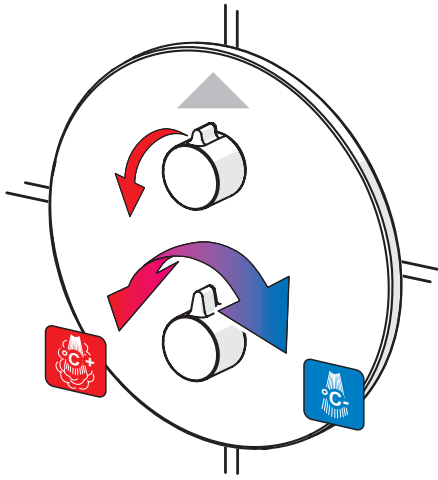

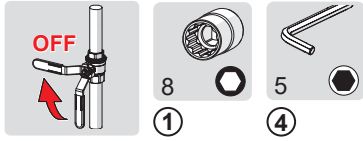

59 914 182

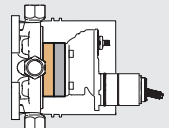

15 mm (max. 30 mm)

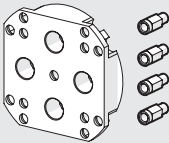

Extension set

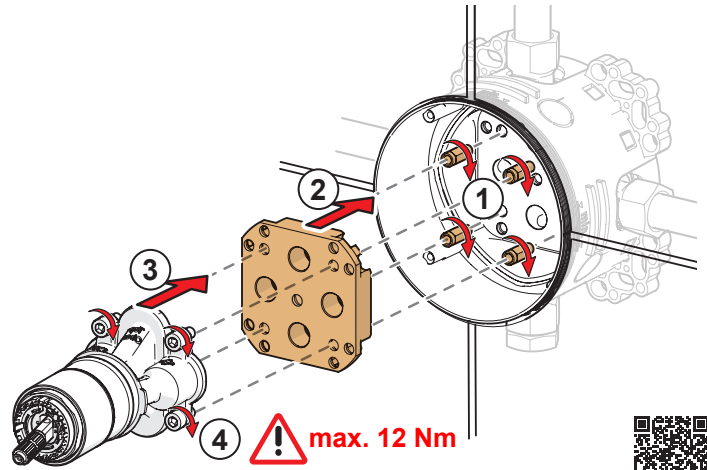

http://movie.hansa.com/blbx_trblshoot_extension

59 914 184

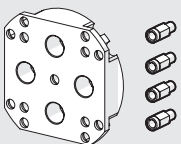
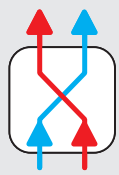

Reverse adapter

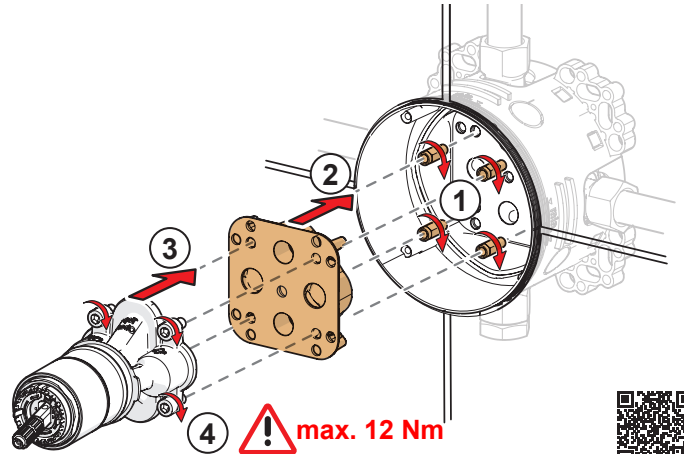

http://movie.hansa.com/blbx_trblshoot_warmcold

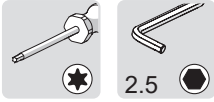

③

④

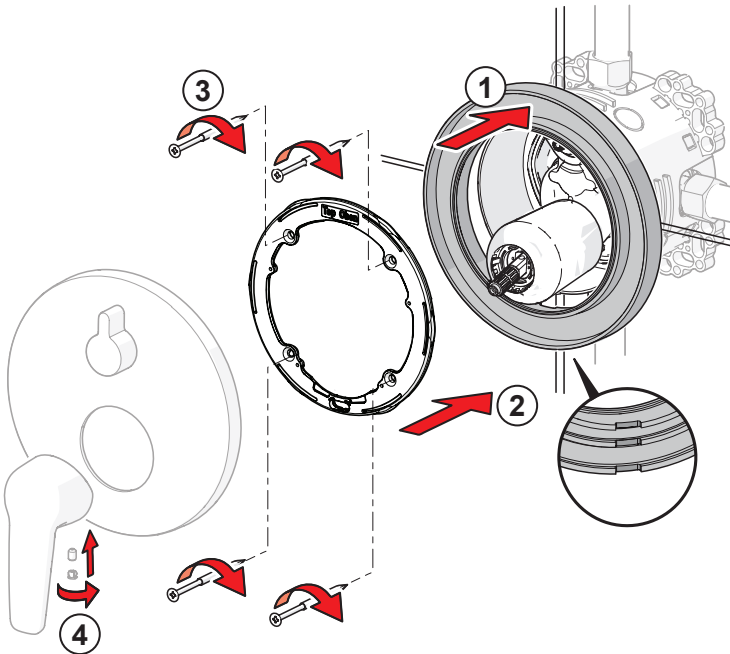

59 914 191

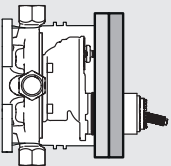

15 mm (max. 30 mm)

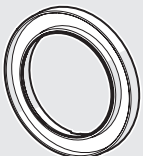

Distance adapter

59 914 192

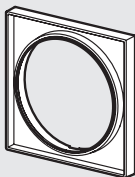

http://movie.hansa.com/blbx_trblshoot_extension

**8871 9052**

I (ISO 3822)
EN 817
50 - 1000 kPa
0.33 l/s (300 kPa)
max. +80°C

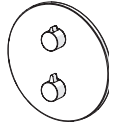
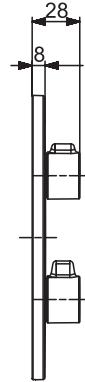
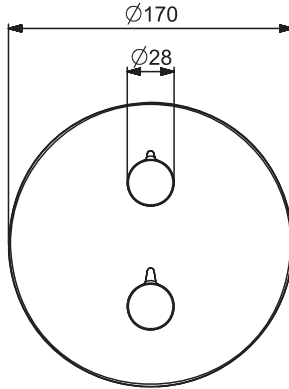

mpi.hansa.com/88719052

8871 9062

I (ISO 3822)
EN 817
50 - 1000 kPa
0.33 l/s (300 kPa)
max. +80°C

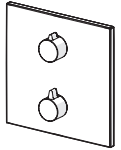
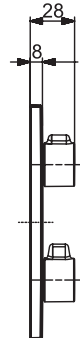
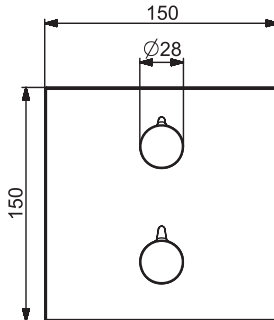

mpi.hansa.com/88719062

8872 9052

I (ISO 3822)
EN 817
50 - 1000 kPa
0.33 / 0.31 l/s (300 kPa)
max. +80°C

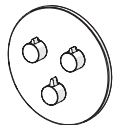
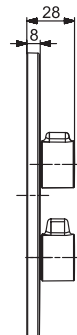
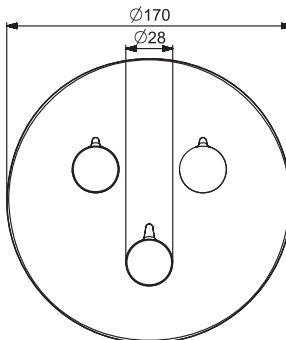

mpi.hansa.com/88729052



8872 9062

I (ISO 3822)
EN 817
50 - 1000 kPa
0.33 / 0.31 l/s (300 kPa)
max. +80°C

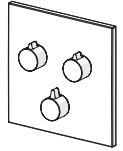
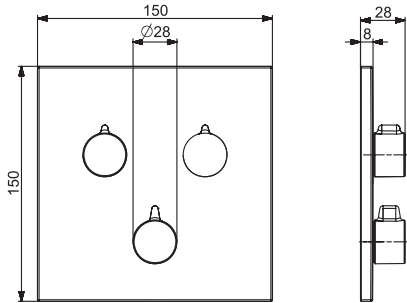

mpi.hansa.com/88729062

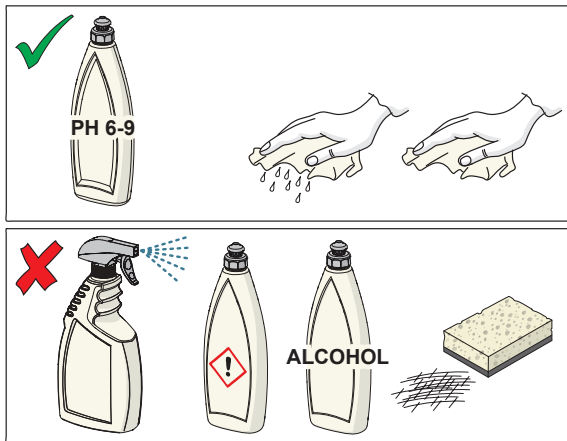

cleaning.hansa.com

About Oras Group

Oras Group is a significant European provider of sanitary fittings: the market leader in the Nordics and a leading company in Continental Europe.

The company's mission is to create the smartest water experiences for everyone and its vision is to become the Perfect Flow Company.

The Group has two strong brands, Oras and Hansa. Oras Group is owned by Oras Invest, a family company, and an industrial owner.

The domicile of Oras Ltd, the parent company of the Group, is located in Rauma, Finland, and the Group has two manufacturing sites: Olesno (Poland) and Rauma (Finland).

The Group operates with its own staff in 17 markets. Oras Group's net sales were 233.5 million euros in 2021 and at the end of the period the company employed 1255 people.

HANSA Armaturen GmbH
P. O. BOX 81 02 40
D-70519 Stuttgart
Sigmaringer Strasse 107
D-70567 Stuttgart
Tel.: +49 711 16 14 0
Fax: +49 711 16 14 368
info@hansa.de
www.hansa.com



943540D-12-25