

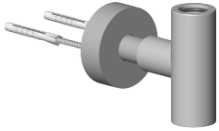











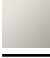

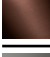

90 17 11 037 00 Produktversion ab 01.04.2025

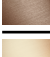

	Chrom	90 17 11 037 00-00
	chrom gebürstet (04)	90 17 11 037 00-04
	Platin gebürstet	90 17 11 037 00-06
	Platin	90 17 11 037 00-08
	Messing (23kt Gold)	90 17 11 037 00-09
	Weiß matt	90 17 11 037 00-10
	Dark Brass matt	90 17 11 037 00-16
	Dark Bronze matt	90 17 11 037 00-17
	Dark Chrome	90 17 11 037 00-19
	Light Gold gebürstet	90 17 11 037 00-27
	Messing gebürstet (23kt Gold)	90 17 11 037 00-28
	Schwarz matt	90 17 11 037 00-33
	Dark Brass gebürstet	90 17 11 037 00-39
	Bronze gebürstet	90 17 11 037 00-42
	Champagne gebürstet (22kt Gold)	90 17 11 037 00-46
	Champagne (22kt Gold)	90 17 11 037 00-47
	Chrom gebürstet	90 17 11 037 00-93
	Dark Platinum gebürstet	90 17 11 037 00-99



Befestigung für Brause Stand T-Stück - Chrom

ERSATZTEILE

90 17 11 037 00 Produktversion ab 01.04.2025



Befestigung für Brause Stand T-Stück - Chrom

ERSATZTEILE

90 17 11 037 00 Produktversion ab 01.04.2025

90 17 11 037 00 Produktversion ab 01.04.2025

Ersatzteile für die
anderen
Oberflächenvarianten
finden Sie hier:
chrom gebürstet (04)

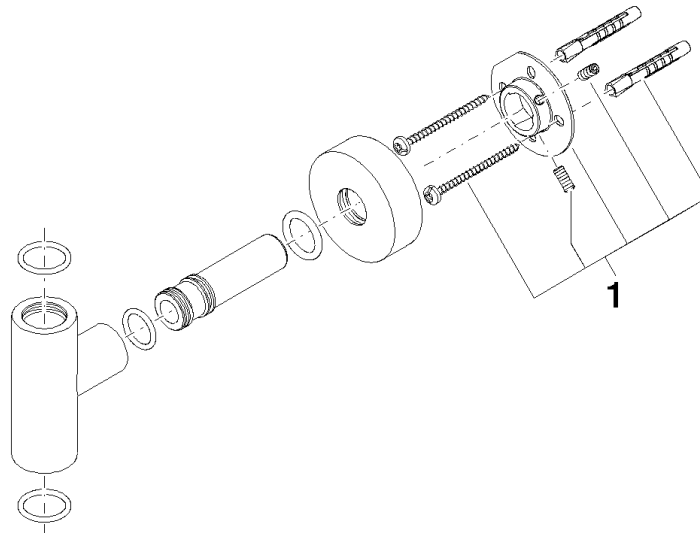

Ersatzteilstückliste

Nr.	Artikelnummer	Benennung	Verbaumenge	Lieferzeit
1	05 17 20 707 00 90	Befestigungssatz 50 x 50 x 10 mm -	1,00	2